

TUSCANY

Residential Gourmet Kitchen



About the clients:

The Francesca's is a family of four came from Tuscany, Italy. Because both the mother and father work, the user who is most involved with food preparation is the sixty-eight year old grandmother who is beginning to experience symptoms of cognitive decline and limited movement. She is a former chef who intends to age in place.

Design Concept:

The purpose of this project is to create a healing environment for a multi-generation family. Since the grandmother of the family has symptoms of limited movement and dementia, rounded edges and corners are more appropriate than sharp ones. Therefore, round and curved cabinets are used. In addition, the identical shapes used from the flooring to the soffit helps people with dementia to orient in the space. For lighting, under cabinet lights are applied in case of additional lighting needed in various areas. The satin finish countertop prevents glare that affects the elderly eyes. The soft and sustainable cork tile flooring added comfort to feet. Social activities are also important for elderly. Since the grandmother is envisioned to be in a wheel chair, bar height counter is decreased to be the same height of the rest of counter. As you go further toward the garden, a small soilless planting area is designed in the nook area so that the grandmother can grow fresh herbs as her daily activity towards dementia treatment. With all these safety features in the space, the grandmother would become more familiar and comfortable as she ages in the place.



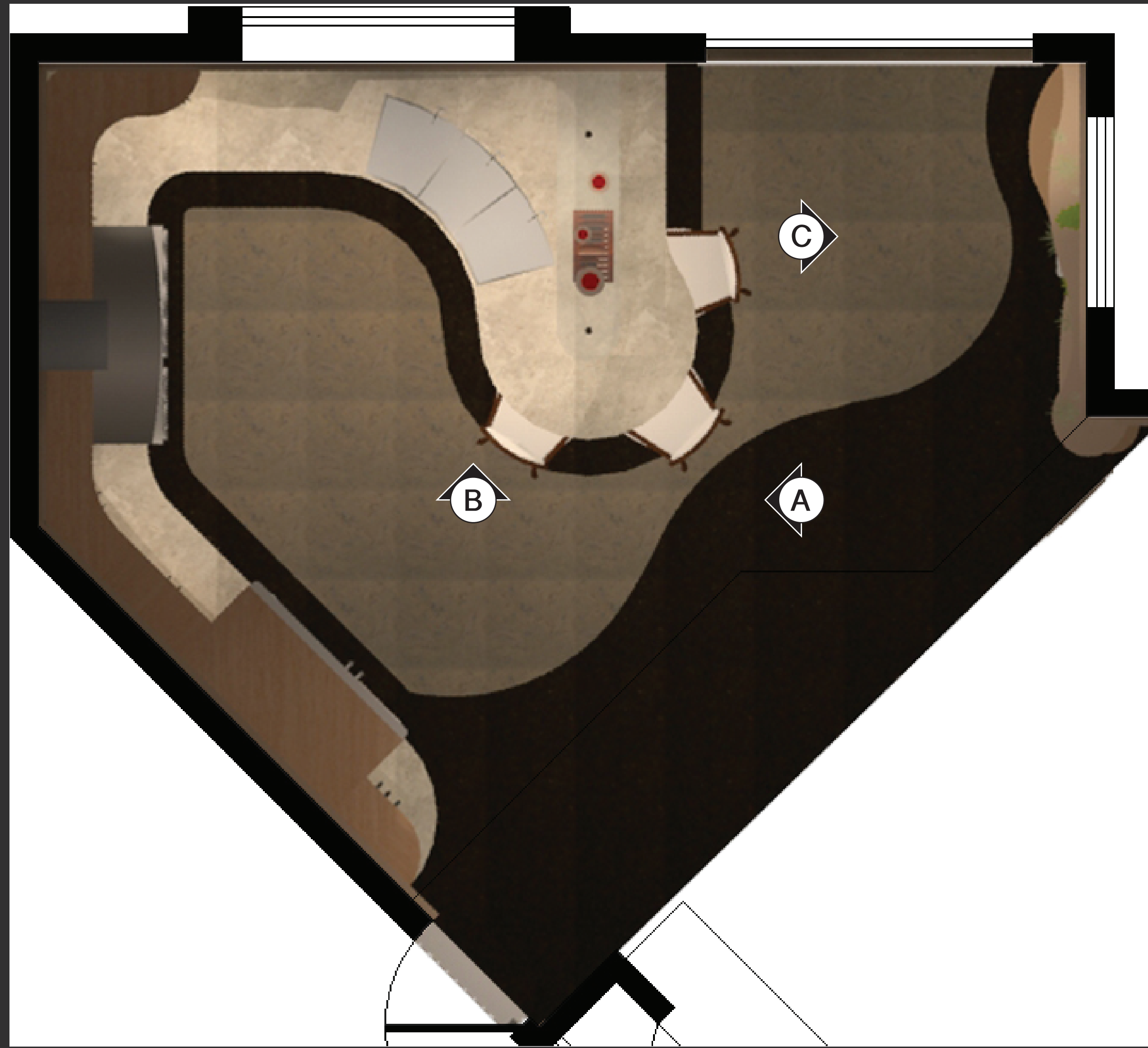

Floor Plan
Metric Scale: 1:20

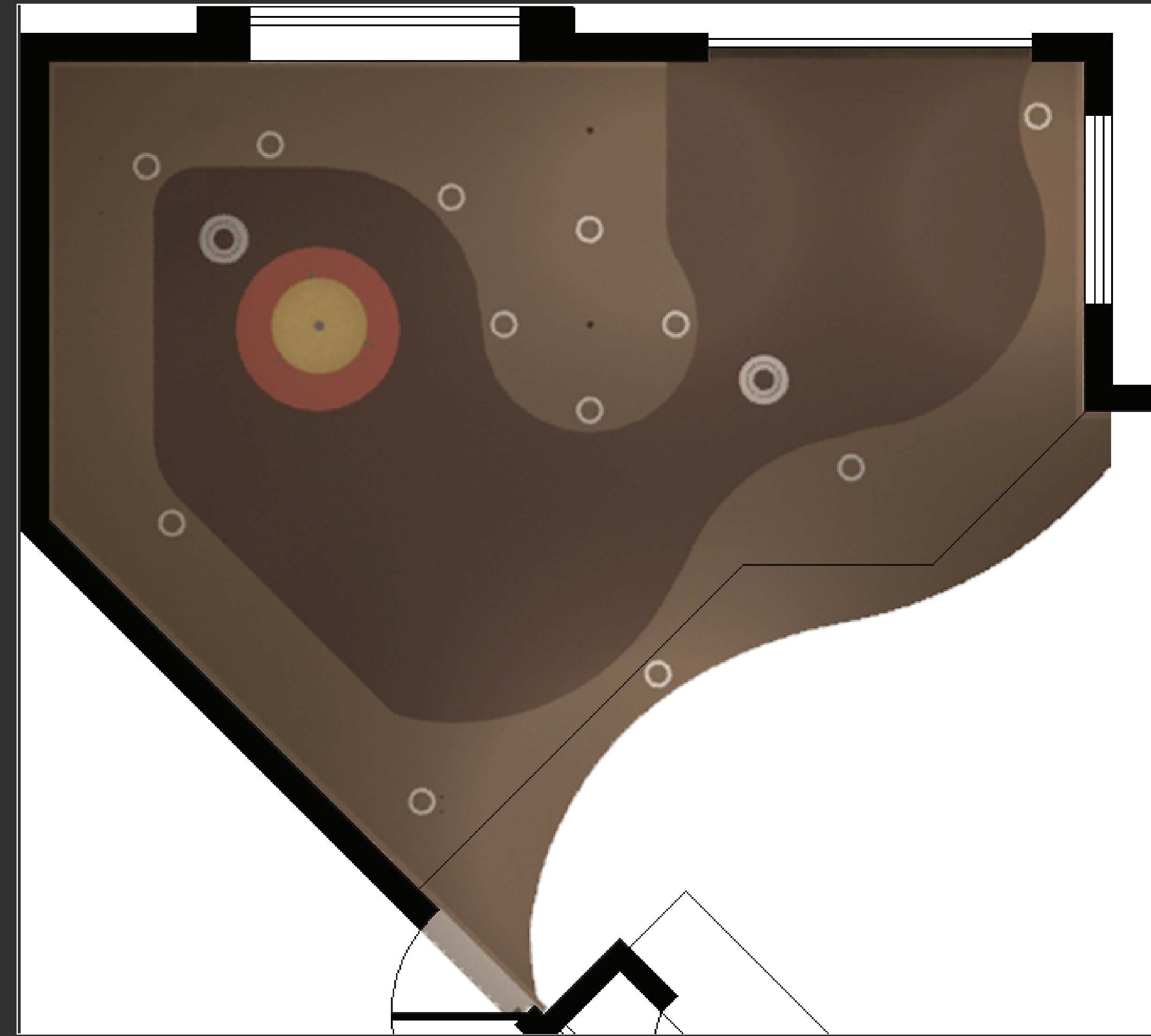

Reflected Ceiling Plan
Metric Scale: 1:20



Elevation A
Metric Scale: 1:20



Elevation B
Metric Scale: 1:20





Elevation C
Metric Scale: 1:20



Nook Area Perspective

Materials & Finishes:

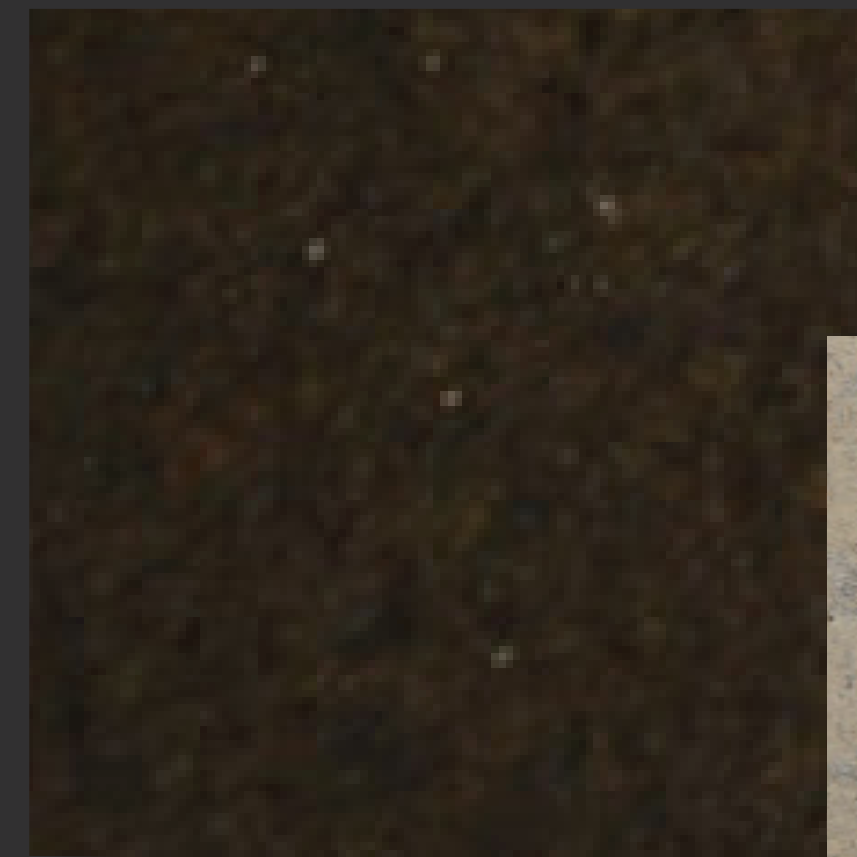

*Cork
Flooring*



*Diamond
Travertine*



*Euro Beige
Wall Finish*

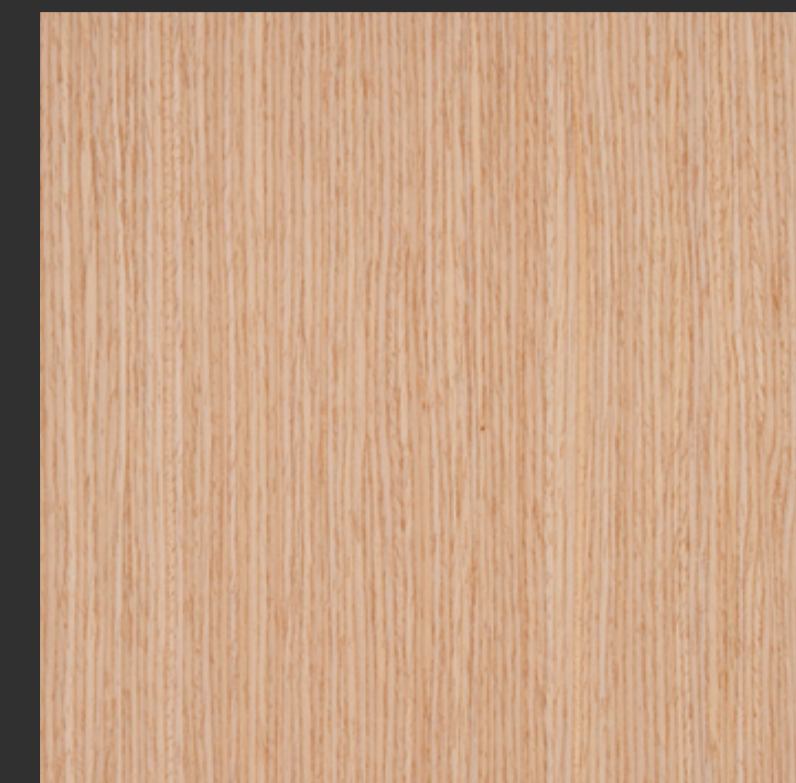

*Rift Cut White Oak
Veneer Cabinet Finish*



*Arctic Gray
Countertop*





Perspective

